

# Premium Booth 3mW x 3mD One side open

SD-E-9  
3mW x 3mD x 3.5mH

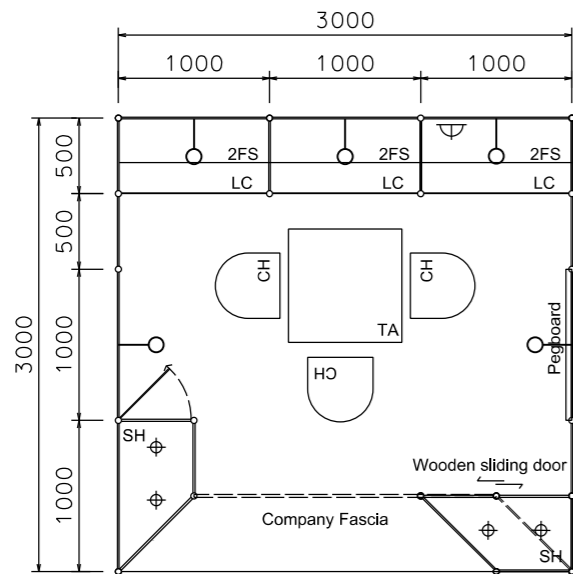

- Company Fascia  
Panel in colour laminate stickers  
-Respect M-3176)  
-Respect M-3173)  
-company name letters in white
- Panel in colour sticker lamination  
-(Respect M-3176)
- Glass showcase with white wooden sliding door  
(1000mmW x500mmD x2500mmH)  
with 2x 50W halogen downlight)
- Glass showcase with white wooden swing door  
(1000mmW x500mmD x2500mmH)  
with 2x 50W halogen downlight)
- Plywd panel in colour sticker laminations  
-(Respect M-3176)  
-(Respect M-3173)



COLOUR PERSPECTIVE N.T.S

PLAN

PERSPECTIVE N.T.S

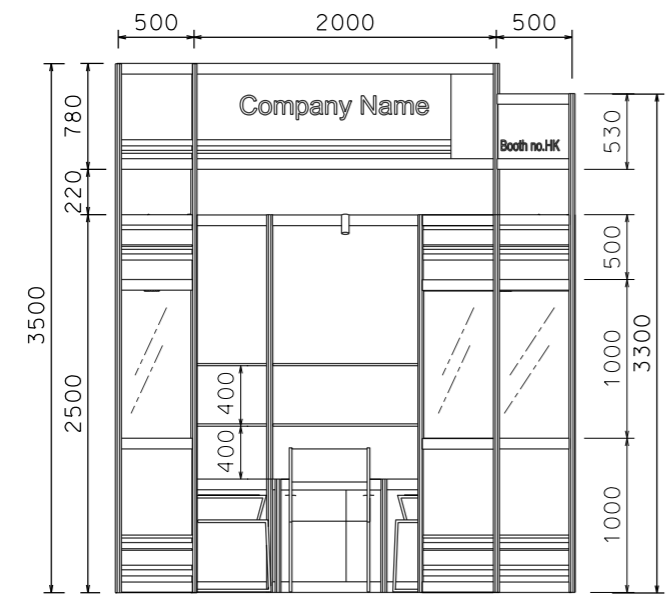

FRONT ELEVATION

BOOTH SPECIFICATION	QTY
Front glass showcase in sticker lamination with white wooden swing door. 2 x (50W) halogen downlight (1m W x 0.5mD x 2.5m H)	1
Front glass showcase in sticker lamination with white wooden sliding doors. 2 x (50W) halogen downlight (1m W x 0.5mD x 2.5m H)	1
Lockable cabinet (1mL x 0.5mD x 0.75mH)	3
Wooden shelf (flat) (1mL x 0.3mD)	6
Pegboard with 30 hooks (1mW x 2.5mH)	1
Square meeting table (0.7m X0.7m x 0.75mH)	1
Black leather chair	3
Longarmed spotlight w/23 watt energy saving lamp (yellow)	5
500w Square pin power socket	1

FILE PATH - L:\Local Fair Premium Booth 2011\SD-Layouts\SD-E layout\SD-E-2dLAYOUT.dgn



**NOTES** UNLESS OTHERWISE SPECIFIED ALL DIMENSIONS ARE IN MM.

.....

.....

.....

REVISION
05-01-2009
07-01-2009
15-01-2009
21-01-2009
12-05-2009
18-05-2009
15-07-2009
20-01-2010

DATE:	20-01-2010
SCALE:	1 : 50 (A3)
DRAWN BY:	..
CHECKED BY:	.....

**TITLE**  
Premium Booth  
SD-E-9

**PROJECT**  
PREMIUM BOOTH  
3m x 3m  
DATE: XXXXXXXX

**SHEET**  
SD-E01